



Link Mfg. Ltd.
223 15th St. N.E.
Sioux Center, IA USA
51250-2120
www.linkmfg.com

**QUESTIONS?
CALL CUSTOMER
SERVICE
1-800-222-6283**

INSTALLATION INSTRUCTIONS

**4AS00007 / 4AS00008
8K & 10K FABRICATED
KNUCKLE ASSEMBLY**



IMPORTANT: IT IS IMPORTANT THAT THE ENTIRE INSTALLATION INSTRUCTIONS BE READ THOROUGHLY BEFORE PROCEEDING WITH THE INSTALLATION.

1. INTRODUCTION





Thank you for choosing a Link Auxiliary Suspension. We want to help you get the best results from this suspension and to operate it safely. This instruction contains information to assist in the installation of the fabricated steering knuckle for your Link Auxiliary Suspension. This instruction is intended solely for use with this product.

All information in this instruction is based on the latest information available at the time of printing. Link Manufacturing reserves the right to change its products or manuals at any time without notice.

Damaged components should be returned to Link with a pre-arranged Returned Materials Authorization (RMA) number through the Customer Service Department. The damaged component may then be replaced if in compliance with warranty conditions.

2. SAFETY SYMBOLS, TORQUE SYMBOL, and NOTES

3. SAFE WORKING PRACTICES

 DANGER	DANGER indicates a hazardous situation which if not avoided, will result in death or serious injury.
 WARNING	WARNING indicates a potentially hazardous situation which, if not avoided, could result in death or serious injury.
 CAUTION	CAUTION indicates a potentially hazardous situation which, if not avoided, could result in minor or moderate injury.
 NOTICE	NOTICE indicates a potentially hazardous situation which, if not avoided, may result in property damage.
 TORQUE	TORQUE indicates named fasteners are to be tightened to a specified torque value.
NOTE:	A Note provides information or suggestions that help you correctly perform a task.

When handling parts, wear appropriate gloves, eyeglasses, ear protection, and other safety equipment.



Proper tightening of fasteners is important to the performance and safety of the suspension. Follow all



torque specifications throughout the instructions.

4. INSTALLATION

For instructional purposes, the proceeding will show the installation of the 4AS00007 - Fabricated Knuckle - Left Hand Side. The installation of the 4AS00008 - Fabricated Knuckle - Right Hand Side is the same.

PRIOR TO INSTALLATION, PACK THE DIMPLES OF THE UPPER AND LOWER STEERING KINGPIN BUSHINGS AND THE BRAKE CAM SHAFT TUBE BUSHINGS WITH MULTI PURPOSE LITHIUM BASED GREASE (NLGI GRADE 2).

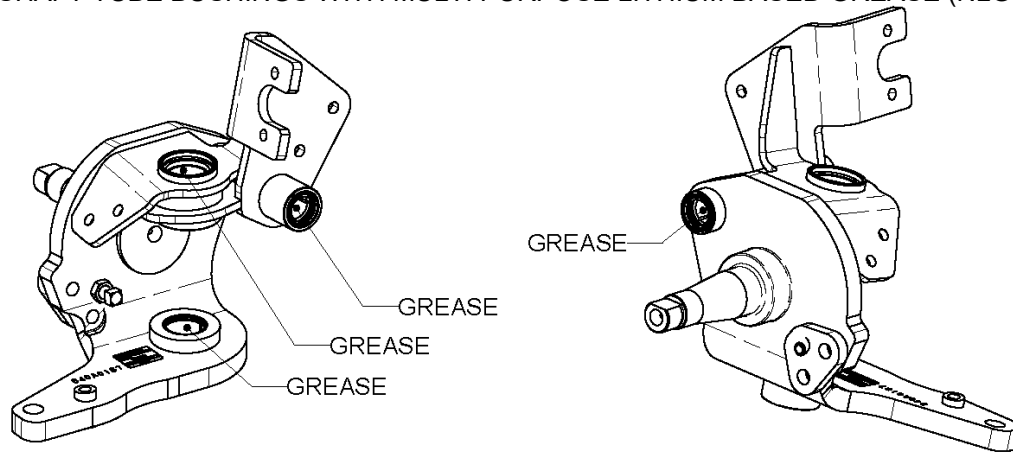

PACK THE THRUST BEARING AND INSTALL IT ONTO THE LOWER KNUCKLE KINGPIN BOSS WITH THE SEAL FACING UP.

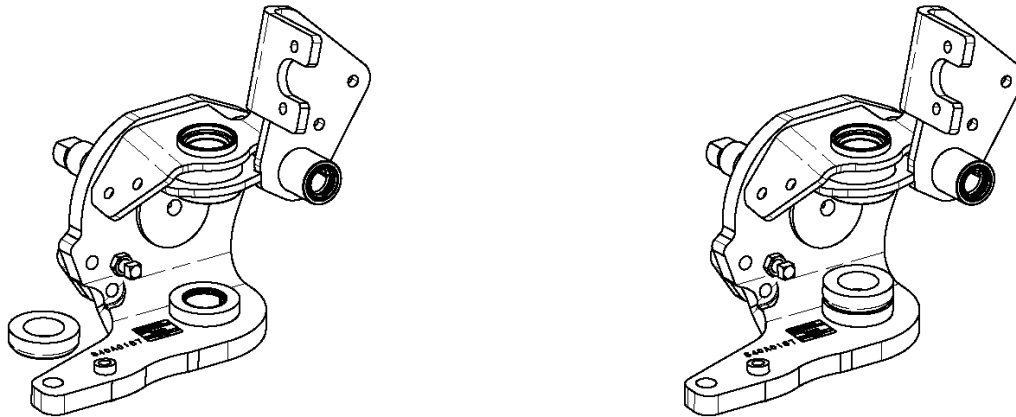

ALIGN THE KNUCKLE WITH THE KINGPIN PIVOT BUSHING ON THE AXLE. WITH THE NUMBERS ON THE KINGPIN FACING DOWN AND THE FLAT SURFACE ON THE KINGPIN ORIENTED WITH THE LOCKING PIN HOLE, INSERT THE KINGPIN FROM THE BOTTOM THROUGH THE KNUCKLE AND AXLE BUSHINGS. INSERT SHIMS AS NECESSARY BETWEEN THE TOP OF THE AXLE BUSHING AND THE BOTTOM OF THE UPPER KNUCKLE BUSHING TO ACHIEVE A VERTICAL PLAY OF 0.002-0.012 INCHES.

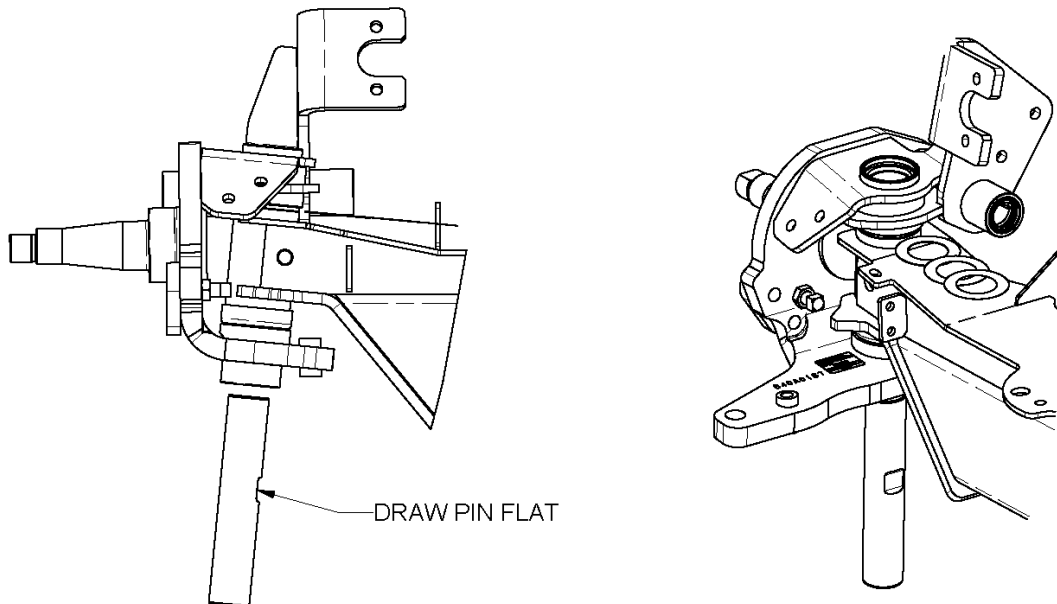

TIGHTEN THE DRAW PIN FASTENER WITH A **TORQUE** OF 35 FT-LBS.

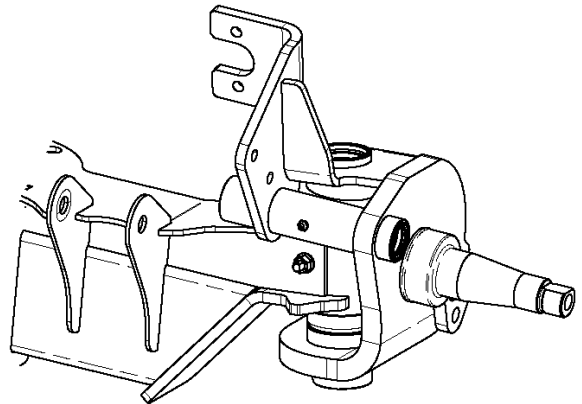
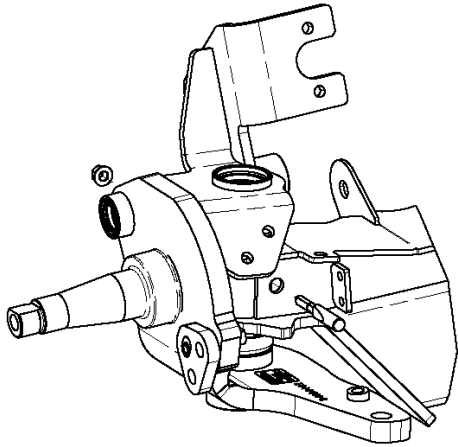

APPLY LOCTITE 76732 ANTI SEIZE TO THE EACH KINGPIN GREASE CAP HOLE. TIGHTEN EACH GREASE CAP WITH A **TORQUE** OF 60 FT-LBS.

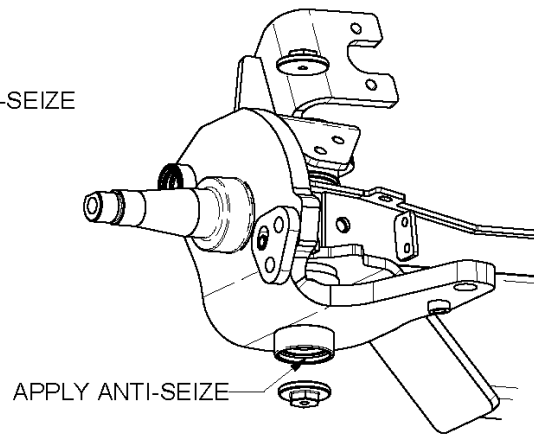
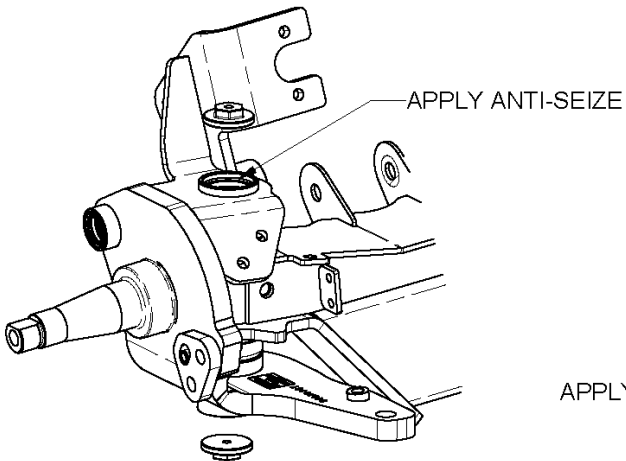

TIGHTEN EACH GREASE ZERK WITH A **TORQUE** OF 25 FT-LBS.

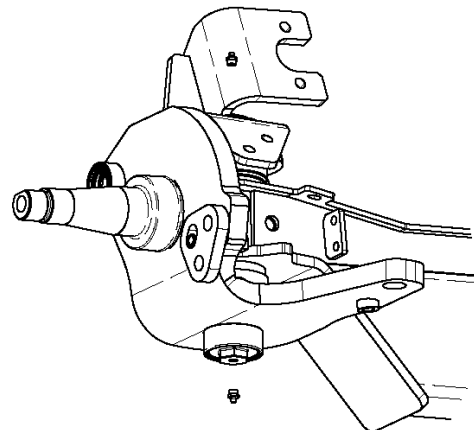
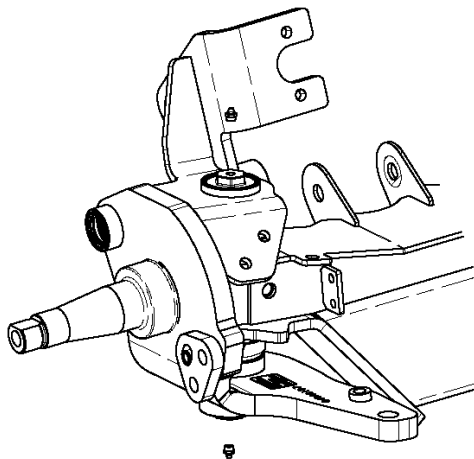

INSTALL THE BRAKE CAM SHAFT AS SHOWN.

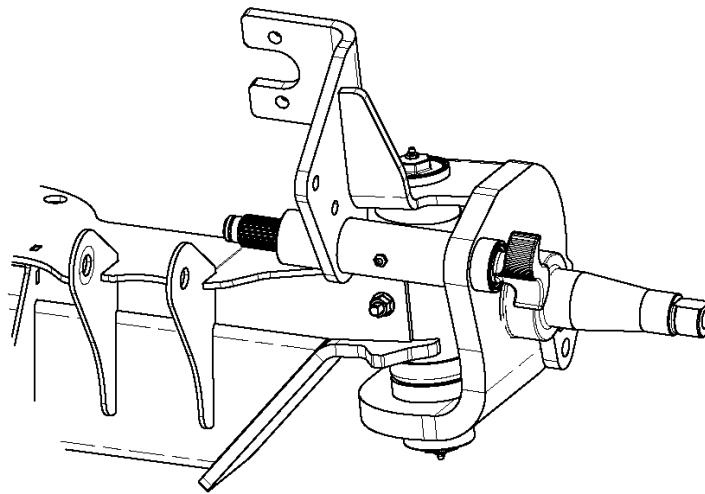
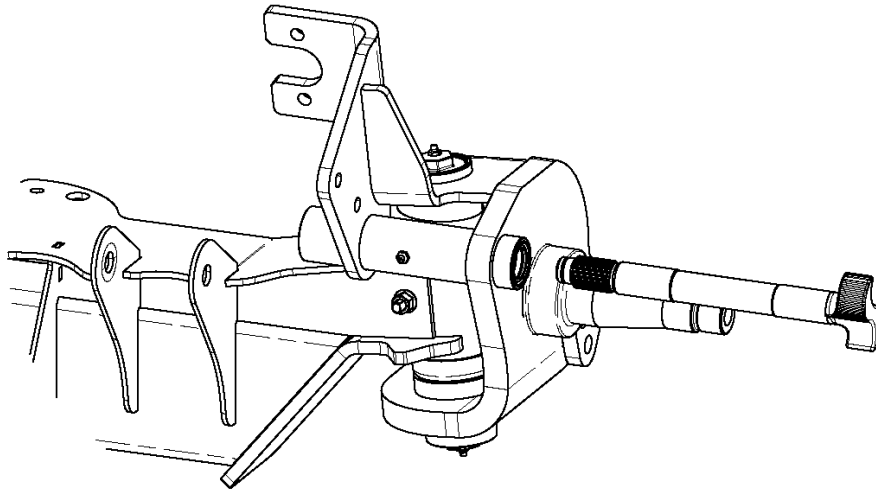

INSTALL THE BRAKE SHOE PINS AS SHOWN. TIGHTEN THE TOP FASTENER FIRST WITH A **TORQUE** OF 200 FT-LBS, THEN THE BOTTOM FASTENER WITH A **TORQUE** OF 200 FT-LBS.

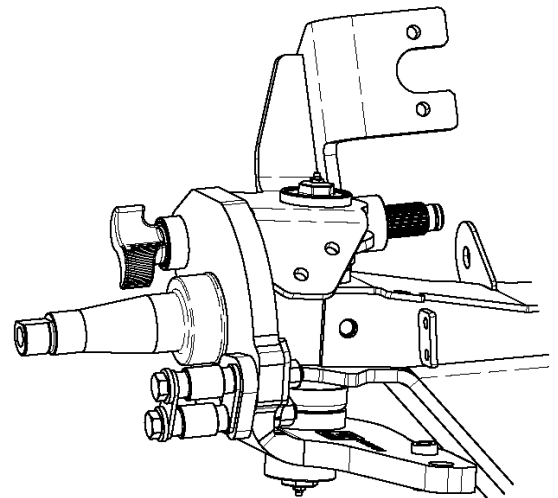
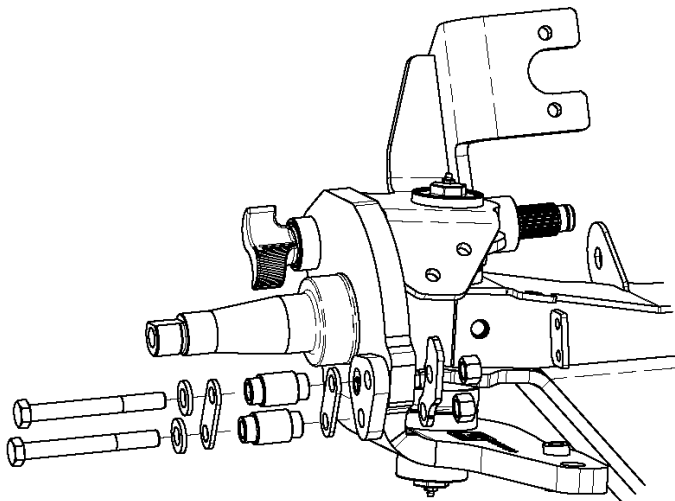

ORIENT AND INSTALL BRAKE SHOES, ROLLERS, AND SPRINGS AS SHOWN.

NOTICE

ORIENTATION OF OUTER SPRINGS ON THE OUTSIDE OF THE BRAKE SHOE RIBS

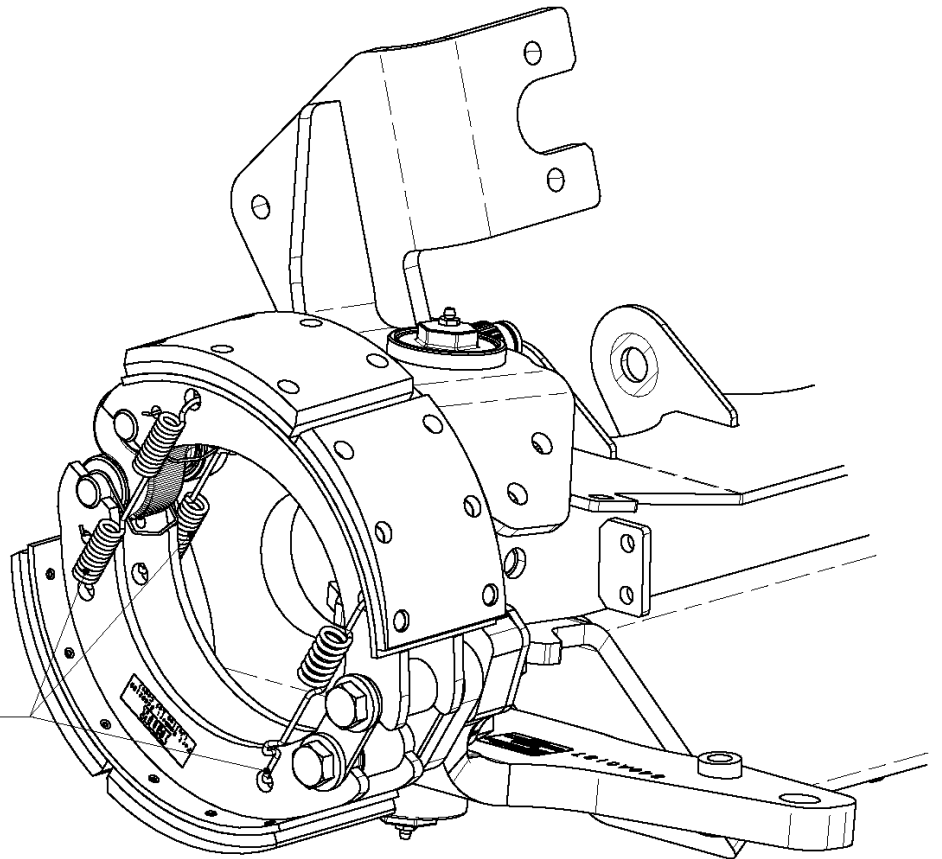

NOTICE

ORIENTATION OF INNER SPRING ON INSIDE BRAKE SHOE BETWEEN SHOE RIBS

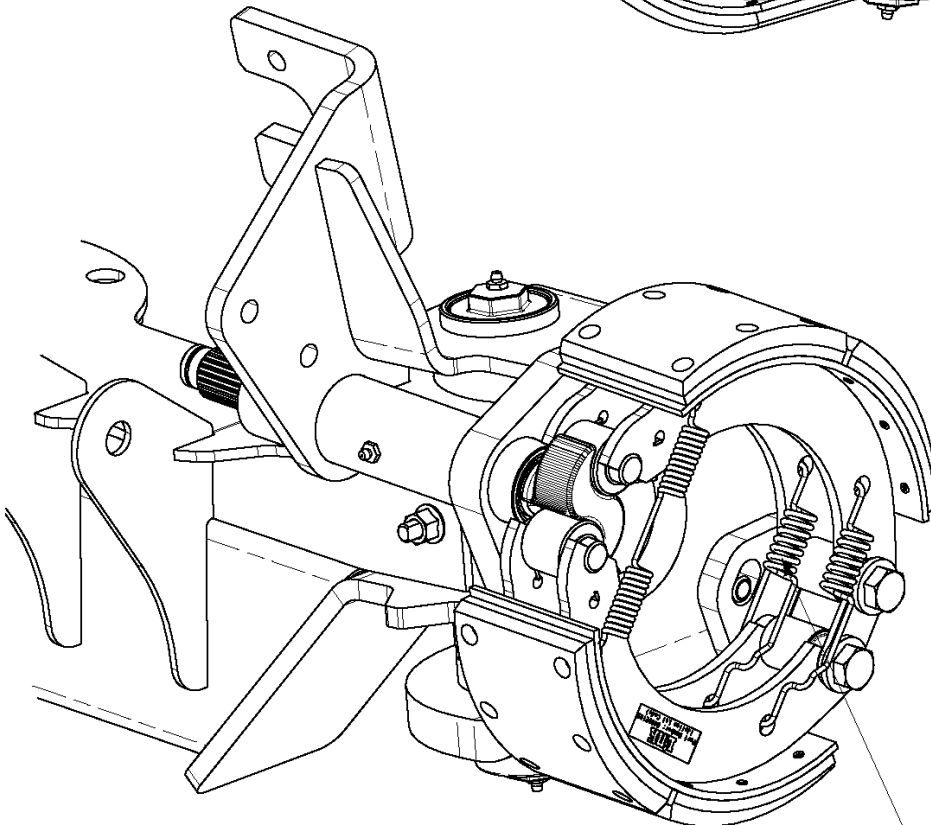

INSTALL THE AIR BRAKE CHAMBER AS SHOWN. TIGHTEN FASTENERS WITH A **TORQUE** OF 62.5 FT-LBS.

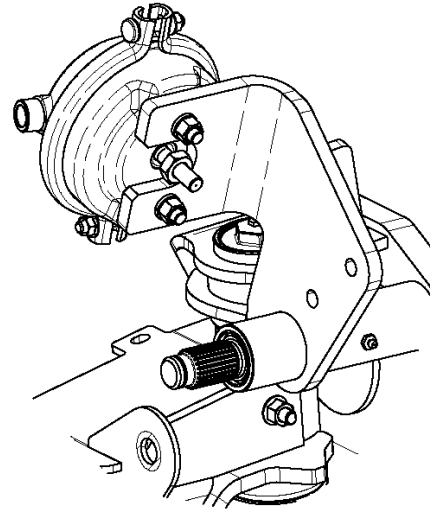
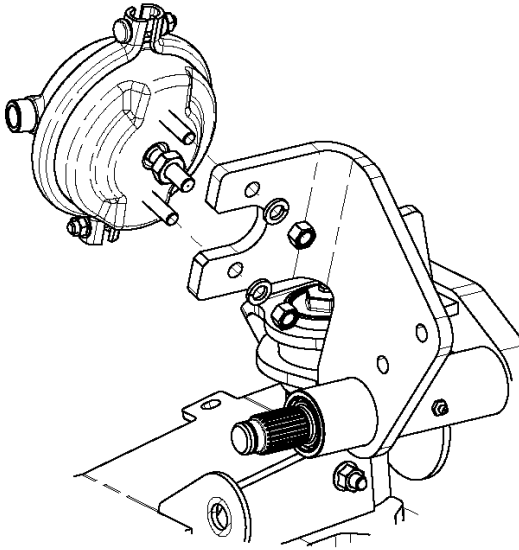

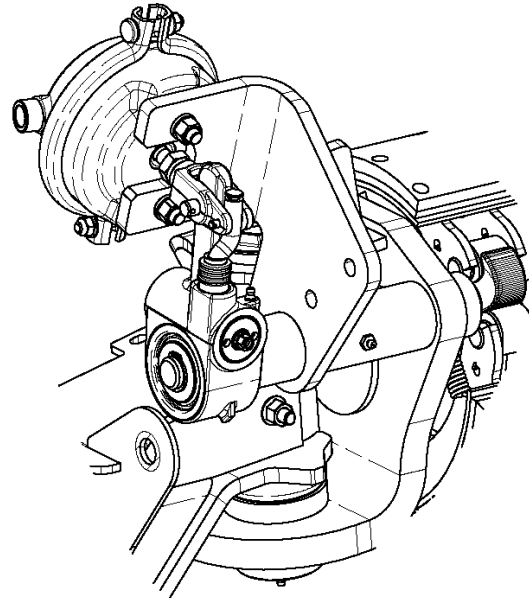
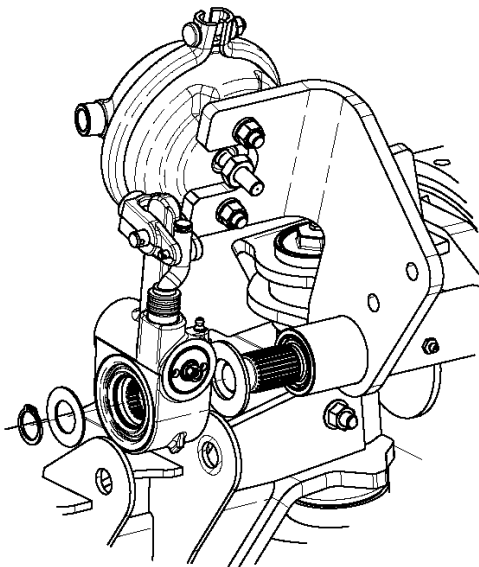

THREAD THE YOKE ONTO THE BRAKE CHAMBER STUD WITH 2 THREADS SHOWING THROUGH THE YOKE. THEN INSTALL THE BRAKE CAM SHAFT WASHERS AND BRAKE ADJUSTER AS SHOWN. SECURE WITH SNAP RING. CHECK SLACK ADJUSTMENT.



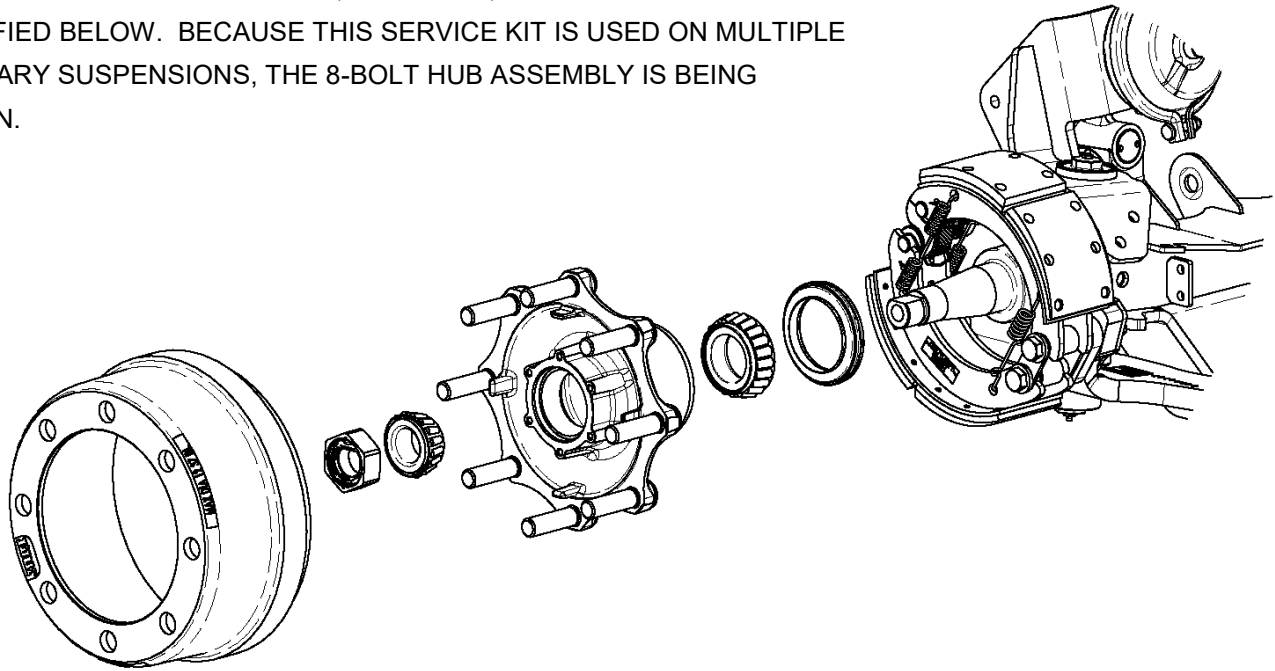

INSTALL WHEEL HUB WITH SEAL, BEARINGS, AND ZIP-TORQ NUT AS SPECIFIED BELOW. BECAUSE THIS SERVICE KIT IS USED ON MULTIPLE AUXILIARY SUSPENSIONS, THE 8-BOLT HUB ASSEMBLY IS BEING SHOWN.



SEAT THE BEARING:

- 1)  **TORQUE** THE NUT TO 200 FT-LBS AND SPIN THE HUB AT LEAST ONE FULL ROTATION.
- 2)  **TORQUE** THE NUT AGAIN TO 200 FT-LBS AND SPIN THE HUB AT LEAST ONE FULL ROTATION.
- 3)  **TORQUE** THE NUT TO 200 FT-LBS AND THEN BACK OFF THE NUT UNTIL LOOSE.

ADJUST THE BEARING:

- 1)  **TORQUE** THE NUT TO 100 FT-LBS AND SPIN THE HUB AT LEAST ONE FULL ROTATION.
- 2)  **TORQUE** THE NUT AGAIN TO 100 FT-LBS AND SPIN THE HUB AT LEAST ONE FULL ROTATION.
- 3)  **TORQUE** THE NUT TO 100 FT-LBS AND THEN BACK OFF THE NUT SLIGHTLY.
- 4) CHECK FOR ACCEPTABLE END PLAY.

INSTALL BRAKE DRUM

ACCEPTABLE END PLAY:

- 1) THE DIAL INDICATOR SHOULD BE ATTACHED TO THE HUB OR BRAKE DRUM WITH ITS MAGNETIC BASE. ADJUST THE DIAL INDICATOR SO THAT ITS PLUNGER IS AGAINST THE END OF THE SPINDLE WITH ITS LINE OF ACTION APPROXIMATELY PARALLEL TO THE AXIS OF THE SPINDLE.
- 2) WITH THE DRUM SECURED TO THE HUB, GRASP THE ASSEMBLY AT 3 O'CLOCK AND 9 O'CLOCK POSITIONS. PUSH AND PULL THE ASSEMBLY IN AND OUT WHILE OSCILLATING THE ASSEMBLY APPROXIMATELY 45 DEGREES. STOP OSCILLATING THE HUB SO THAT THE DIAL INDICATOR TIP IS IN THE SAME POSITION AS IT WAS BE OSCILLATING BEGAN. READ THE BEARING END-PLAY AS THE TOTAL INDICATOR MOVEMENT.
- 3) **ACCEPTABLE END PLAY IS .001" - .005".**

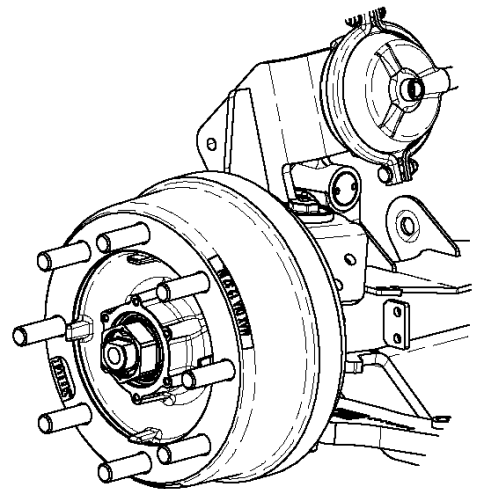

INSTALL HUB CAP WITH GASKET. TIGHTEN FASTENERS WITH A **TORQUE** OF 15 FT-LBS.

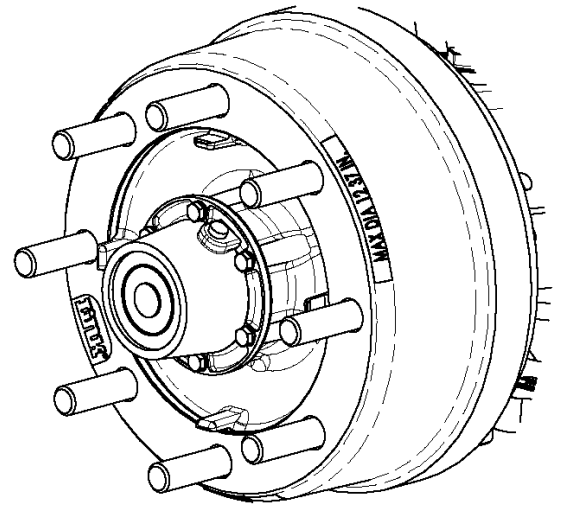
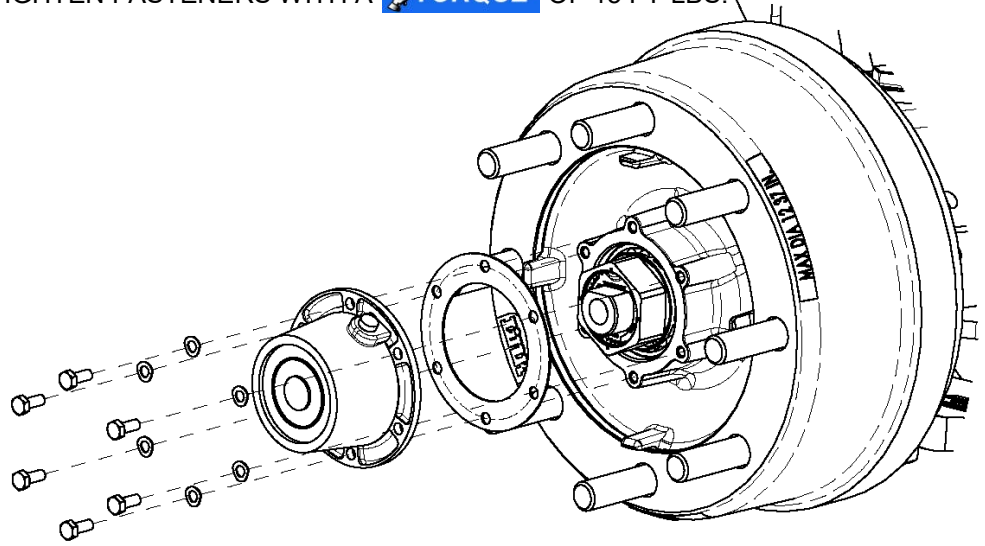

REMOVE OIL FILL PLUG FROM HUB CAP AND FILL WITH OIL (SAE 80W/90 MINERAL BASED) TO THE TOP OF THE OIL LINE. RE-INSTALL OIL PLUG INTO HUB CAP.

INSTALL REVERSE LOCK IF REVERSE LOCK WAS PREVIOUS INSTALLED. TIGHTEN MOUNTING BRACKET FASTENERS WITH A **TORQUE** OF 35 FT-LBS.

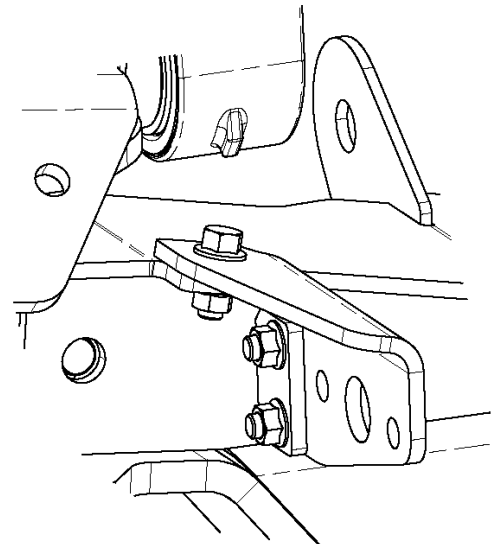
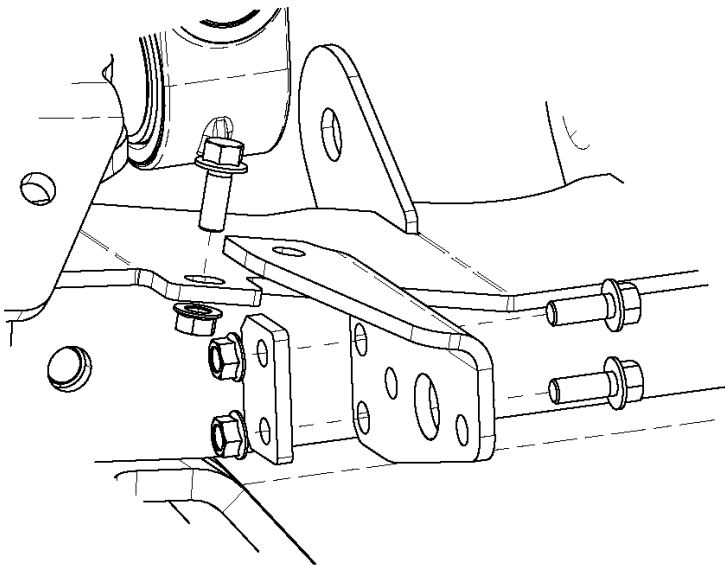

TIGHTEN STOP TUBE WELDMENT AND AIR CHAMBER FASTENERS WITH A **TORQUE** OF 25 FT-LBS.

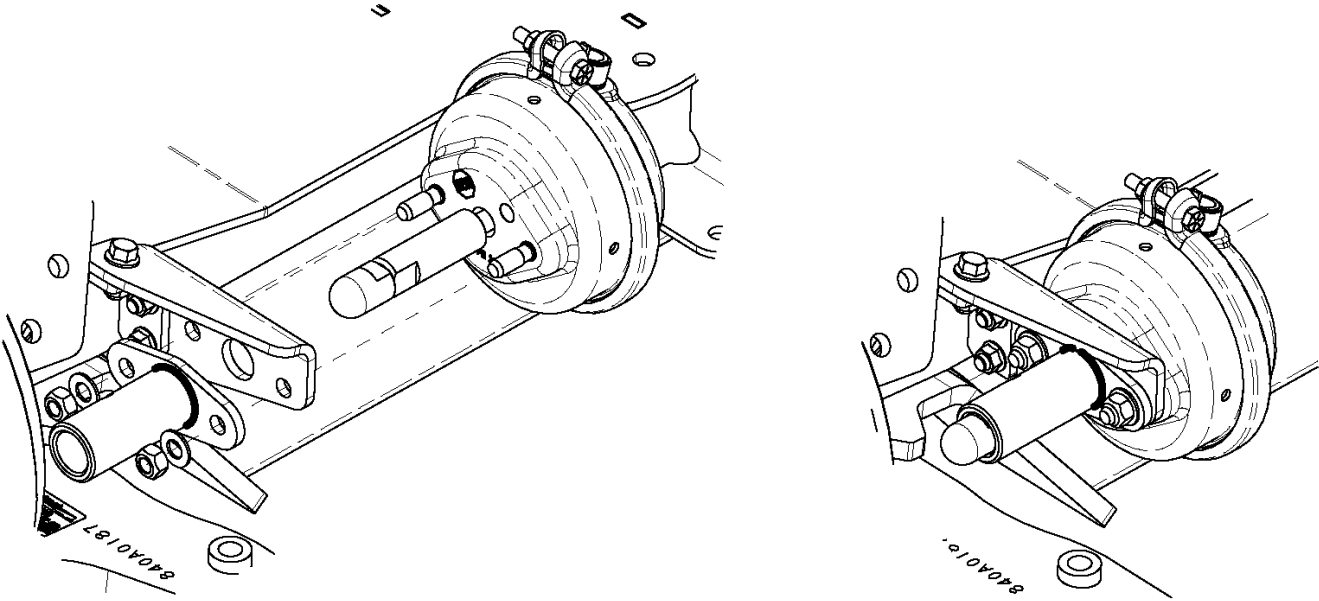

RE-INSTALL FENDER BRACKETS TO STEERING KNUCKLE IF PREVIOUSLY EQUIPPED. TIGHTEN THE REAR MOUNTING BRACKET FASTENERS TO THE KNUCKLE WITH A **TORQUE** OF 100 FT-LBS. FOR ILLUSTRATION CLARITY PURPOSES, FENDERS AND ALUMINUM FENDER ARMS ARE NOT SHOWN.

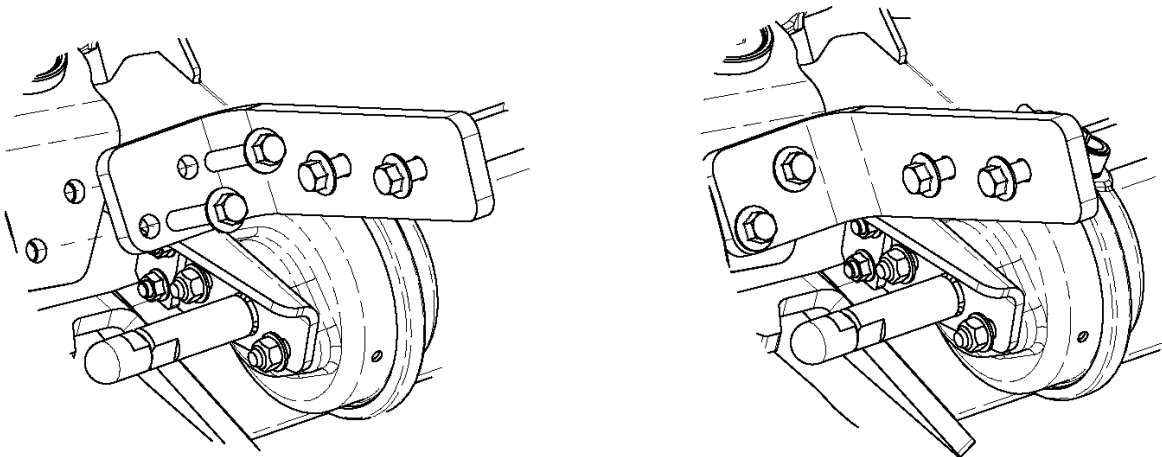

TIGHTEN THE FRONT MOUNTING BRACKET FASTENERS TO THE KNUCKLE WITH A **TORQUE** OF 50 FT-LBS. FOR ILLUSTRATION CLARITY PURPOSES, FENDERS AND ALUMINUM FENDER ARMS ARE NOT SHOWN.

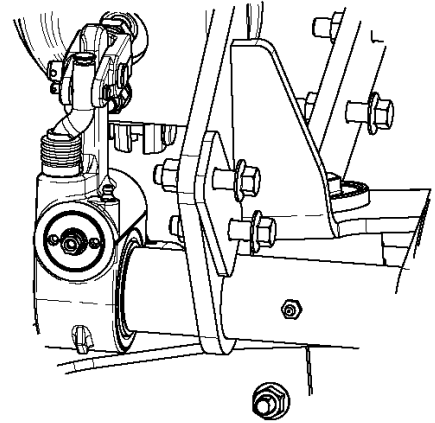
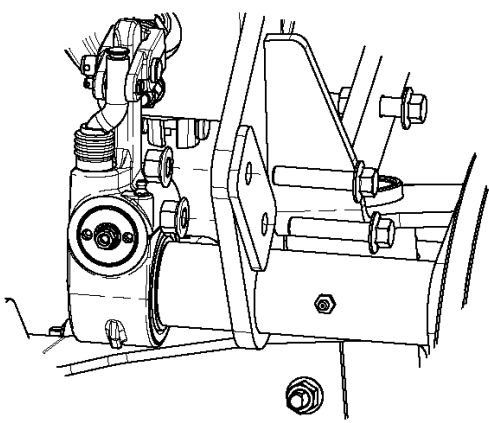

RE-CONNECT TIE ROD ASSEMBLY. TIGHTEN CASTLE NUT WITH A **TORQUE** OF 140 FT-LBS. IF NECESSARY, CONTINUE TO TIGHTEN CASTLE NUT TO INSTALL COTTER PIN.

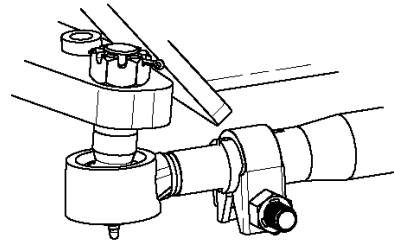
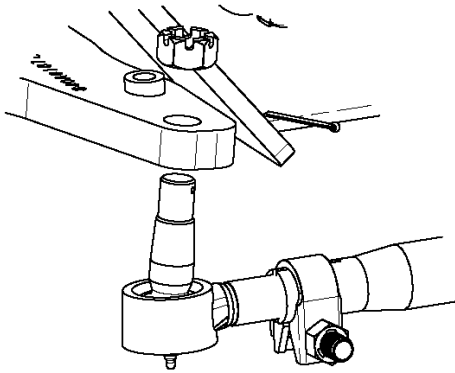

RE-CONNECT STEERING SHOCK ABSORBER. TIGHTEN FASTENERS WITH A **TORQUE** OF 85 FT-LBS.

